

Thermoforming Machine

RotoCREA 2012

Cannon smart response to high-level **automotive** industry needs.

Single station thermoforming machine producing car interior trims with **vacuum forming** or **thermocovering** techniques, with turning table concept.

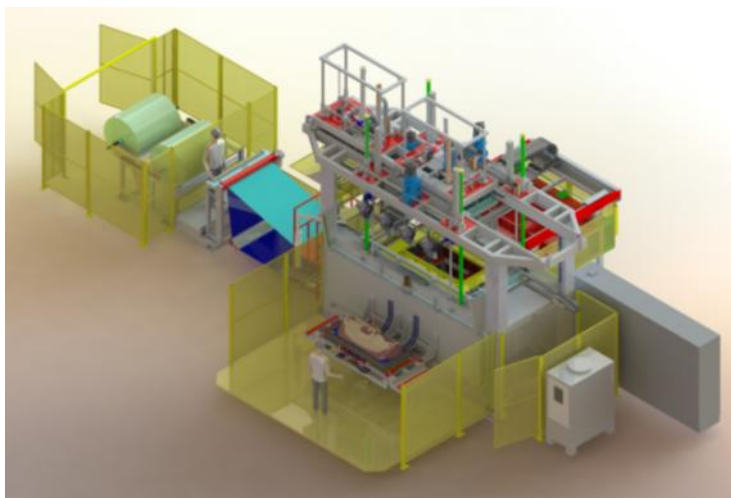

MAIN FEATURES

- Fast cycle time due to double mold, one in forming area, one in operator area
- Easy manual operations with mold accessibility on 3 sides
- Forming and pre-cutting in the same station
- Automatic reel feeding with devices for junction

GENERAL DATA

Max forming aperture	2000 x 1200 mm
Pieces	Dashboard skins
Productivity	30 - 40 pieces/hour
Raw material	TPO in rolls
Thickness	1.2 – 1.5 mm



**Solution when accurate manual operations,
like skin de-molding or inserts loading,
are requested in high productivity applications**

FEEDING SYSTEM

- Reel frame carrying two coils of material
- Manual junction between finishing reel and new one
- Curved aluminum chute to prevent the material from touching the floor
- Motorised gripping system to unroll, lay and tension the material
- Transverse cutter on the clamp frame

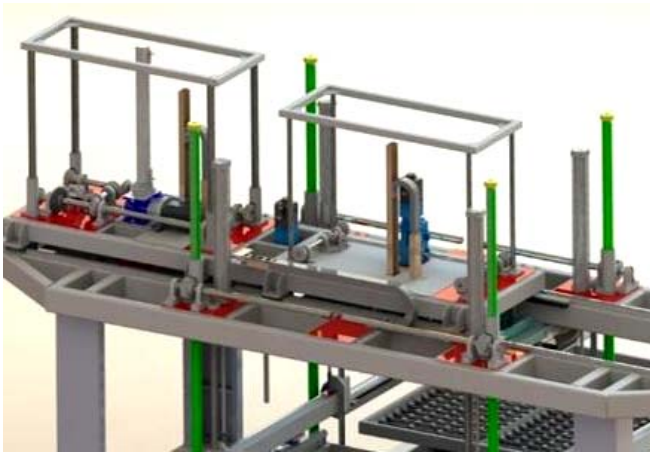

Shuttling upper platen with plug assist and cutting

HEATING AND PROCESS CONTROL

- Two heating banks of quartz lamps, several half-sized, individually controlled
- PLC and operative panel: optimized heating process with a close-loop temperature control
- Automatic retraction of lower heater in case of emergency
- Heating and cooling pyrometers
- Proportional valve of slow vacuum and automatic bubble and sheet sag control

FORMING AND DE-MOLDING DEVICES

- Rotating closing gate with double mold table: forming on one mold and manual de-molding on the other at the same time
- Completely dedicated and changeable aperture plate and clamp frame
- Shuttling upper platen: plug assist against wrinkles and set of blades for cutting
- Completely servo-electric movements with rack and pinion systems
- Dedicated auto-centring reduction plates for the molds
- Mold model identification



Ergonomics of rotating double mold table